

© This drawing and the building work depicted on the copyright of the Architect and shall be reproduced or used in any form whatsoever without the written consent of the Architect. All construction shall be in accordance with the drawings. The Architect shall not be responsible for the design and construction of any structure shown on these drawings. Latham are to be held responsible for any variation between drawings and the construction.

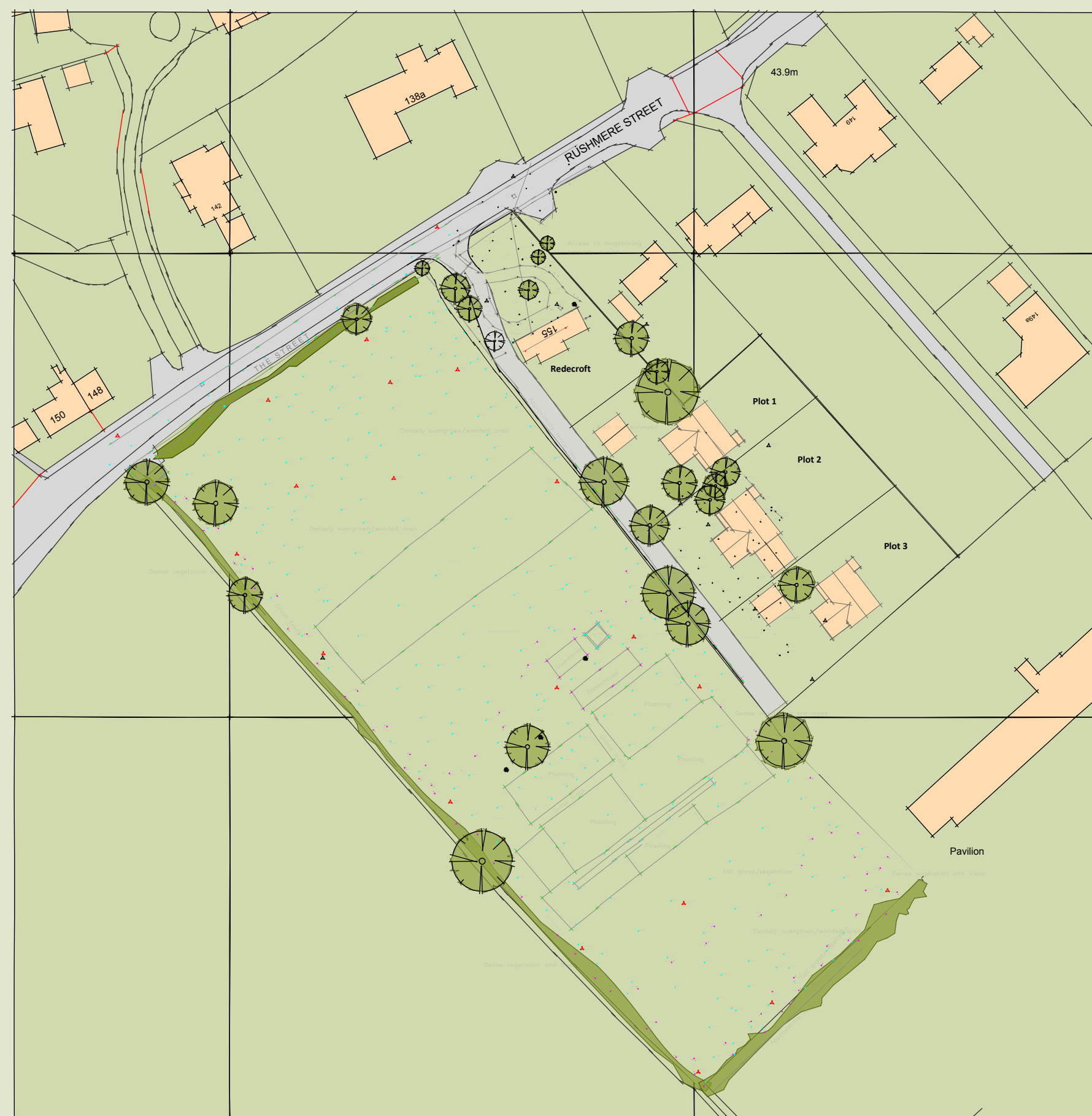

Ordnance Survey, (c) Crown Copyright 2013. All rights reserved. Licence number 100020449

The site as existing



Ordnance Survey, (c) Crown Copyright 2013. All rights reserved. Licence number 100020449

The site as proposed with phase 1 - plots 1,2 and 3

VILLAGE HOUSING PROPOSAL THE STREET : RUSHMERE ST ANDREW



St. Michael's, Queen Street, Derby, DE1 3SU
Tel: 01332 365777 - Fax: 01332 290314
enquiries@lathamarchitects.co.uk
www.lathamarchitects.co.uk
Chartered Architects
Urban Designers
Landscape Architects
Town Planners
Historic Building & Conservation Advisors

