

**KEY**

- St. Joseph's Home Site Boundary ownership
- Existing Home
- Outline of area to be demolished (circa GEA 309 sq.m)  
Existing wing (circa GIA 290 sq.m)
- New Proposed Extension (circa GEA 430 sq.m)  
New Proposed Extension (circa GIA 392 sq.m)

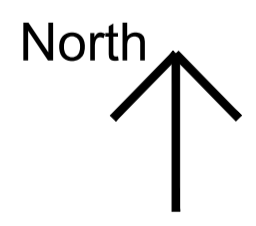

Rev	Note	Scale	Size	By	Date
		1:200	@A1		
<b>Date:</b>	23.04.18	<b>Status:</b>	PL		
<b>Drawn:</b>	NG	<b>Checked:</b>	DH		
<b>Job No:</b>	742	<b>Drg No:</b>	402		
<b>Title:</b>	PHASE 4 PROPOSED SITE LAYOUT PLAN				
<b>Project:</b>	St Joseph's Home Manchester				
<b>Client:</b>	Little Sisters of the Poor				

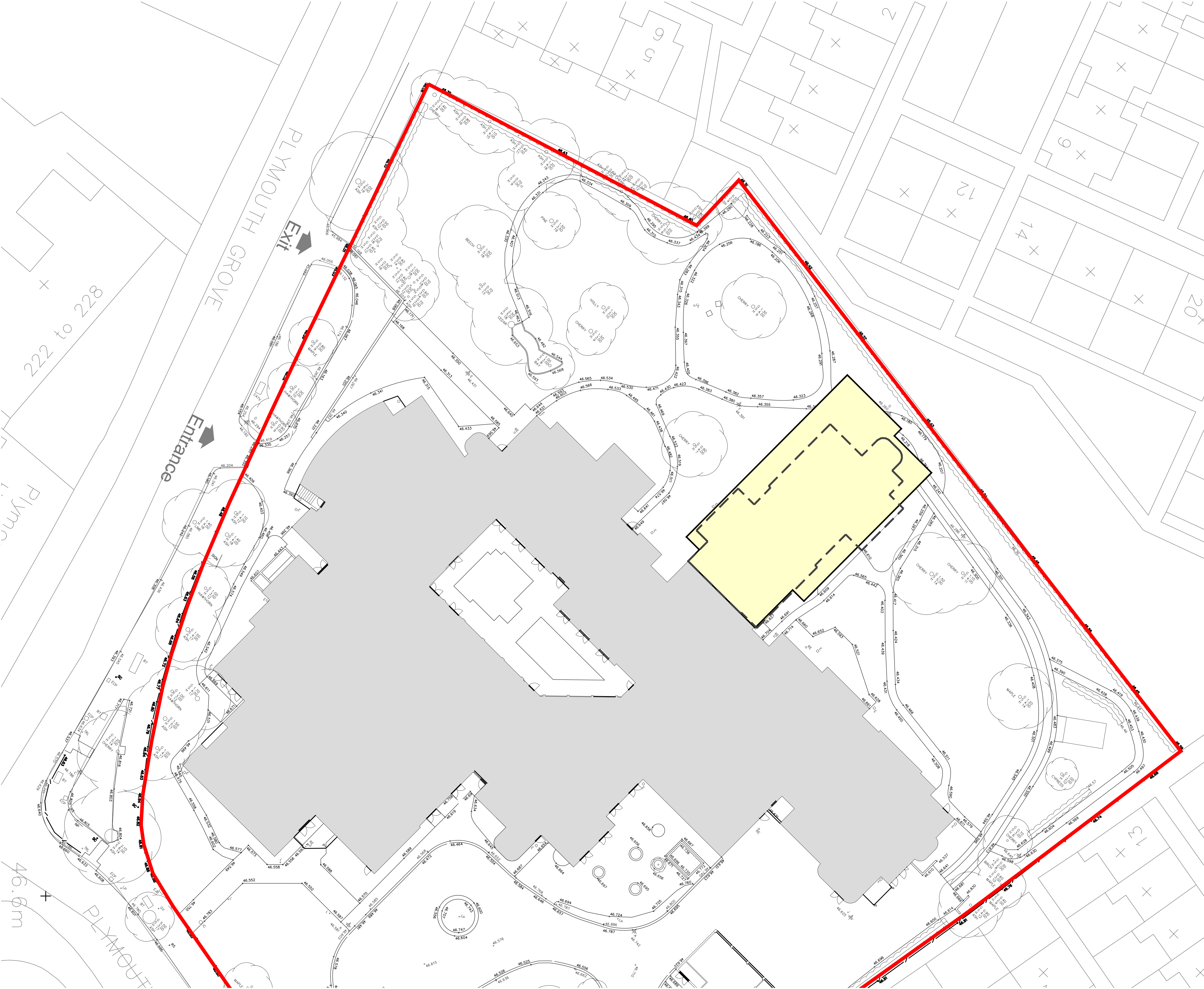